



Addendum No. 2

Project: **St James Hurricane Harvey Repairs**
Diocese of Beaumont

Date: **1-25-21**

All bidders are herewith notified of the following additions, deletions, changes or clarifications to the drawings dated January 11, 2022 and shall be acknowledged as received on the proposal.

1. Attached is the sign in sheet from the Pre-Proposal meeting held on January 24, 2022.
2. General Contractor shall sign and attach the enclosed non-collusion and debarment forms with the sealed proposals.
3. Davis-Bacon Wages and Certified Payroll will not be required on this project.
4. See attached Revised Sheet A101:
Include in Alternate #1 the cost to remove loose paint from plaster, clean and paint the wall located on the left side of the Sanctuary as discussed in the Pre-Proposal Meeting. See attached.

End of Addendum # 2



Date: 1-25-2022



350 Pine Street Suite 720
 Edison Plaza
 Beaumont, TX 77701
 Phone: 409.866.7196
 Fax: 409.866.1745

PRE-BID ATTENDEES' LIST

Project Number: 21074
Project Name: St. James Catholic Church Port Arthur Hurricane Harvey Repairs
Project Owner: Diocese of Beaumont
Project Address: 3617 Gulfway Drive, Port Arthur, Texas 77642
Date / Time: Thursday, January 24, 2022 / 2:00 PM

| NAME | COMPANY | EMAIL |
|------------------|----------------------|--------------------------------|
| Jared Holt | Delle | ledelke@gt.rr.com |
| CRAIG BUESIO | Acc-Pro FAB | craig@acc-profab.com |
| JOSE CARDENAS | CMST | JCARDENAS@CMOSETX.COM |
| Daniel Hess | McInnis Construction | daniel@mcinnisconstruction.com |
| Tony Aguilar Jr. | H.B. Neild | taguilar@hbneild.com |
| LARRY GUIDRY | MIKE BARNETT CONST | lguid1313@yahoo.com |
| | | |
| | | |
| | | |
| | | |
| | | |
| | | |
| | | |
| | | |
| | | |
| | | |
| | | |
| | | |
| | | |
| | | |
| | | |
| | | |



THE AMERICAN INSTITUTE OF ARCHITECTS



350 Pine Street Suite 720
 Edison Plaza
 Beaumont, TX 77701
 Phone: 409.866.7196
 Fax: 409.866.1745

PRE-BID ATTENDEES' LIST

Project Number: 21074
Project Name: St. James Catholic Church Port Arthur Hurricane Harvey Repairs
Project Owner: Diocese of Beaumont
Project Address: 3617 Gulfway Drive, Port Arthur, Texas 77642
Date / Time: Thursday, January 24, 2022 / 2:00 PM

| NAME | COMPANY | EMAIL |
|-------------------|-------------------------|-----------------------------------|
| MARCUS CATO | BABCO CONST | BCTPAYABLES1025@AOL.COM |
| Matthew Ruppissly | W3 Kanger Builders | matthew@w3kanger.com |
| Michael Green | SETEX Construction | michaelg@setexconstruction.com |
| Charisse Crockett | Honesty Environmental | Charisse@honestyenvironmental.com |
| McLAIN McDONALD | LJL GENERAL CONTRACTORS | lanalinc@att.net |
| RUSSELL BOURGEOIS | MIKE BARNETT CONST. | rbourgeoismbca@gmail.com |
| LANCE BARNETT | " " " | lanceusa11@gmail.com |
| | | |
| | | |
| | | |
| | | |
| | | |
| | | |
| | | |
| | | |
| | | |
| | | |
| | | |
| | | |
| | | |



THE AMERICAN INSTITUTE OF ARCHITECTS

February 8, 2022

**CERTIFICATION REGARDING DEBARMENT, SUSPENSION AND
OTHER RESPONSIBILITY MATTERS**

PROJECT: St. James Hurricane Harvey Repairs

OWNER: Diocese of Beaumont

The Bidder certifies to the best of its knowledge and belief that the Bidder, the Bidder principals and any other entities owned or controlled by Bidder or Bidder's principal(s):

1. Are not presently debarred, suspended, proposed for debarment, and declared ineligible or voluntarily excluded from covered transactions by any Federal, State or local instrumentalities.
2. Have not within the last (5) years before Bid opening been convicted of or had a civil judgment rendered against them for commission of fraud or a criminal offense in connection with obtaining, attempting to obtain, or performing a public (Federal, State, or local) transaction or contract under a public transaction; violation of Federal or State antitrust statutes or commission or embezzlement, theft, forgery, bribery, falsification or destruction of records, making false statements, or receiving stolen property.
3. Are not presently indicted for or otherwise criminally or civilly charged by a government entity (Federal, State, or local) with commission of any of the offenses enumerated in paragraph 1 of this certification; and
4. Have not within the last (5) years before Bid opening had one or more transactions terminated for cause or default.

I understand that a false statement on this certification may be grounds for rejection of this Bid and/or termination of the award.

Name and Title of Authorized Representative

Signature of Authorized Representative

Date

_____ I am unable to certify to the above statements. My explanation is attached.



February 8, 2022

NON-COLLUSION STATEMENT

PROJECT: St. James Hurricane Harvey Repairs

OWNER: Diocese of Beaumont

State of Texas
Jefferson County

_____, states that he/she is
_____ (a partner of the firm, officer of the corporation, or individual making the foregoing proposal or bid); that said proposal is genuine and not collusive or sham; that said proposer has not colluded, conspired, connived or agreed, directly or indirectly, with any bidder or person to put in a sham bid or to refrain from bidding, collusion, or communication or conference, with any person, to fix the bid or affiant or any other bidder, or to fix any overhead, profit or cost element, or that of any other proposer, or to secure any advantage against any person interested in the proposed contract, and that all statements contained in the said bid or proposal are true.

(Signature)

THE PRINCIPALS OF THE COMPANY ARE:

PRESIDENT: _____

VICE-PRESIDENT: _____

SECRETARY: _____

TREASURER: _____

BIDDER: _____

(Signature)

NAME: _____

(Print or Type)

ADDRESS: _____

CITY, STATE, ZIP: _____

AREA CODE & PHONE: _____

AREA CODE & FAX: _____

SCOPE OF WORK NOT IN FEMA REPORT

- EAST ALCOVE (THE SAME ISSUE AS WEST ALCOVE BUT NOT COVERED IN REPORT)**
(ALTERNATE #1)
 EA-1 WATER AND MOISTURE DAMAGE TO WALLS AND CEILINGS CREATING MOLD AND PEELING PAINT CAUSED BY WIND AND DRIVEN RAIN LEAKING THROUGH ROOF
 PHOTO: CH-A
 FINAL SCOPE - REMOVE LOOSE PAINT AND RE-PAINT WALL AND CEILING
- NAVE**
(ALTERNATE #2)
 N-1 WATER AND MOISTURE DAMAGE TO PAINT BELOW WOOD RAILING
 PHOTO: N-A, N-B, N-C
 FINAL SCOPE - REMOVE LOOSE PAINT AND RE-PAINT WALL FROM TOP OF WOOD WAINSCOT TO BOTTOM OF WOOD TRIM

FEMA SCOPE OF WORK

- CHOIR**
- CH-1 690 SF OF PLASTER WALLS, 65.24' LONG X 10.58' HIGH, WATER AND MOISTURE WATER AND MOISTURE DAMAGE TO WALLS CREATING MOLD AND PEELING PAINT CAUSED BY WIND DRIVEN RAIN ENTERING THROUGH LOUVERS ON THE BELL TOWER
 PHOTO: CH-A
 FINAL SCOPE - REMOVE AND REPLACE 690 SF OF PLASTER WALL
- CH-2 690 SF OF PAINT WALLS 65.24' LONG X 10.58' HIGH, WATER AND MOISTURE WATER AND MOISTURE DAMAGE TO WALLS CREATING MOLD AND PEELING PAINT CAUSED BY WIND DRIVEN RAIN ENTERING THROUGH LOUVERS ON THE BELL TOWER
 PHOTO: CH-A
 FINAL SCOPE - PAINT WALLS
- CH-3 370 SF OF PLASTER CEILING, 17.58' LONG X 13.42' WIDE, + 13.38' LONG X 10' WIDE, WATER AND MOISTURE WATER AND MOISTURE DAMAGE TO WALLS CREATING MOLD AND PEELING PAINT CAUSED BY WIND DRIVEN RAIN ENTERING THROUGH LOUVERS ON THE BELL TOWER
 PHOTO: CH-B, CH-C, CH-F
 FINAL SCOPE - REMOVE ENTIRE PLASTER CEILING AND REPLACE WITH NEW.
- CH-4 370 SF OF COMMERCIAL CARPET AND PAD, 17.58' X 31.42 AND WIDE X 13.38' LONG X 10' WIDE, WATER AND MOISTURE DAMAGE TO FLOORING CAUSED BY WIND DRIVEN RAIN ENTERING THROUGH LOUVERS ON THE BELL TOWER
 PHOTO: CH-D, CH-E
 FINAL SCOPE - CARPET HAS BEEN REMOVE BY OWNER INSTALL NEW COMMERCIAL CARPET.
- CH-5 370 SF OF VCT (UNDER CARPET), 17.58' X 31.42 AND WIDE X 13.38' LONG X 10' WIDE, WATER AND MOISTURE DAMAGE TO FLOORING CAUSED BY WIND DRIVEN RAIN ENTERING THROUGH LOUVERS ON THE BELL TOWER
 FINAL SCOPE - NOT IN CONTRACT
- CH-6 370 SF OF PAINT CEILING, 17.58' LONG X 10.58' HIGH, WATER AND MOISTURE WATER AND MOISTURE DAMAGE TO WALLS CREATING MOLD AND PEELING PAINT CAUSED BY WIND DRIVEN RAIN ENTERING THROUGH LOUVERS ON THE BELL TOWER
 PHOTO: CH-B, CH-C, CH-F
 FINAL SCOPE - PAINT ENTIRE PLASTER CEILING

WEST ALCOVES (A and B)

- WA-1 288 SF OF PLASTER, 8' LONG 4' WIDE X 7' HIGH WATER AND MOISTURE DAMAGE TO WALLS AND CEILINGS CREATING MOLD AND PEELING PAINT CAUSED BY WIND AND DRIVEN RAIN LEAKING THROUGH ROOF
 PHOTO:ALCOVE A - WA-A, WA-B, WA-C
 PHOTO:ALCOVE B - WA-D, WA-E, WA-F
 FINAL SCOPE - REMOVE AND REPLACE 288 SF OF PLASTER WALLS AND CEILING IN ALCOVE
- WA-2 288 SF OF PAINT, 8' LONG 4' WIDE X 7' HIGH WATER AND MOISTURE DAMAGE TO WALLS AND CEILINGS CREATING MOLD AND PEELING PAINT CAUSED BY WIND AND DRIVEN RAIN LEAKING THROUGH ROOF
 PHOTO:ALCOVE A - WA-A, WA-B, WA-C
 PHOTO:ALCOVE B - WA-D, WA-E, WA-F
 FINAL SCOPE - PAINT WALLS AND CEILING.

SACRISTY ROOM 1

- SR-1 347 SF OF PLASTER CEILING, 22.17' LONG X 15.67' WIDE, WATER AND MOISTURE DAMAGE TO CEILING CREATING MOLD AND PEELING PAINT CAUSED BY WIND DRIVEN RAIN LEAKING THROUGH ROOF
 PHOTO: SR-B, SR-C
 FINAL SCOPE - REMOVE AND REPLACE ENTIRE SF PLASTER CEILING
- SR-2 347 SF PAINT CEILING, 22.17' LONG X 15.67' WIDE, WATER AND MOISTURE DAMAGE TO CEILING CREATING MOLD AND PEELING PAINT CAUSED BY WIND DRIVEN RAIN LEAKING THROUGH ROOF
 PHOTO: SR-B, SR-C
 FINAL SCOPE - PAINT CEILING
- SR-3 160 SF OF PLASTER WALL, 16' LONG X 10' HIGH, WATER AND MOISTURE DAMAGE TO CEILING CREATING MOLD AND PEELING PAINT CAUSED BY WIND DRIVEN RAIN LEAKING THROUGH ROOF
 PHOTO: SR-A, SR-B
 FINAL SCOPE - REMOVE AND REPLACE 160 SF PLASTER WALL.
- SR-4 160 SF OF WALL PAINT, 16' LONG X 10' HIGH, WATER AND MOISTURE DAMAGE TO WALL CREATING MOLD AND PEELING PAINT CAUSED BY WIND DRIVEN RAIN LEAKING THROUGH ROOF
 PHOTO: SR-A, SR-B
 FINAL SCOPE - PAINT 160 SF OF WALL

SACRISTY ROOM 2

- S-1 259 SF OF PLASTER CEILING, 16.5' LONG X 15.67' WIDE, WATER AND MOISTURE DAMAGE TO CEILING CREATING MOLD AND PEELING PAINT CAUSED BY WIND DRIVEN RAIN LEAKING THROUGH ROOF
 PHOTO: S-A, S-B, S-C, S-D, S-E, S-F
 FINAL SCOPE - REMOVE AND REPLACE ENTIRE PLASTER CEILING. REMOVE HVAC METAL DUCT, PAINT AND REINSTALL.
- S-2 259 SF OF PAINT CEILING, 16.5' LONG X 15.67' WIDE, WATER AND MOISTURE DAMAGE TO CEILING CREATING MOLD AND PEELING PAINT CAUSED BY WIND DRIVEN RAIN LEAKING THROUGH ROOF
 PHOTO: S-A, S-B, S-C, S-D, S-E, S-F
 FINAL SCOPE - PAINT CEILING

GENERAL NOTES

- WHERE PLASTER WALLS ARE BEING REPLACED, REMOVE, CLEAN AND REINSTALL OUTLET AND LIGHT SWITCH PLATES. REMOVE A/C DUCTS (PAINT), A/C GRILLES (CLEAN) AND REINSTALL. REMOVE ALL SURFACE MOUNTED CONDUITS AND REINSTALL AFTER PLASTER HAS BEEN REPLACED AND PAINTED.
- WHERE PLASTER CEILINGS ARE BEING REPLACED, REMOVE AND REINSTALL LIGHT FIXTURES, A/C GRILLES (CLEAN), HEAT/SMOKE DETECTORS, AND AUDIO VISUAL DEVICES. REMOVE ALL SURFACE MOUNTED CONDUITS AND REINSTALL AFTER PLASTER HAS BEEN REPLACED AND PAINTED.
- WHERE PLASTER IS BEING REPLACED, REMOVE AND REPLACE SILL AND APRON TRIM AFTER PLASTER HAS BEEN REPLACED AND PAINTED

SEE SHEETS A106 AND A107 FOR PHOTOS

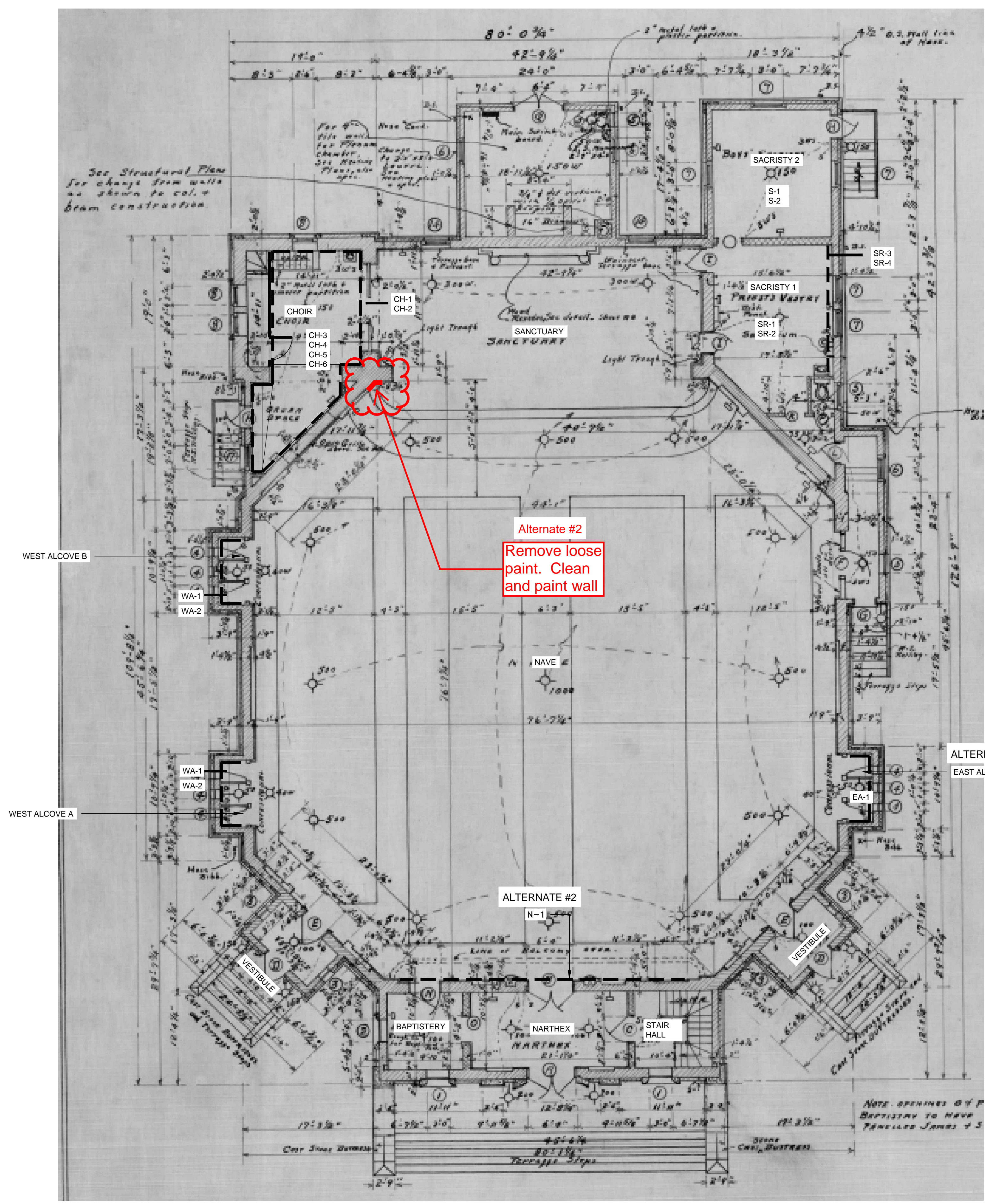

1 FIRST FLOOR PLAN - MAIN BUILDING
 SCALE: 1/8" = 1'-0"